

## LONDON BOROUGH OF ENFIELD

### THE ENFIELD (WAITING AND LOADING) (AMENDMENT NO. 274) ORDER 2026

**NOTICE IS HEREBY GIVEN** that the Council of the London Borough of Enfield (the Council) made on 9 March 2026 the above Order under section 6 and 124 and Part IV of Schedule 9 of the Road Traffic Regulation Act 1984, as amended, and all other enabling powers and after consultation with the Commissioner of Police of the Metropolis.

1. The general effect of the Orders which come into force on 19<sup>th</sup> March 2026 will be to:
  - (1) Extend the existing “at any time” waiting restrictions on:
    - (a) **Barbot Close**, the north-west side, from the common boundary of Nos. 1 and 2 to a point 4.4 metres south of the common boundary of Nos. 6 and 7 Barbot Close.
    - (b) **Byland Close**, the north-west side, from the southwestern kerb-line of The Glade and a point 5 metres south-west of that point.
    - (c) **Tasmania Terrace**, the south-east side, from the south-western kerb-line of Queensland Avenue to a point 12 metres south-west of the common boundary of Nos. 9 and 11 Tasmania Terrace.
  - (2) Introduce new “at any time” waiting restrictions on:
    - (a) **Barbot Close**, the south-east side, from a point 1.5 metres south-west of a point opposite the common boundary of Nos. 6 and 7 Barbot Close to a point 1.1 metres south-west of the northern building line of Nos. 43 to 51 Barbot Close, and from a point 11.1 metres south-west of the north-eastern flank wall of flats 43 to 51 Barbot Close to the southern extent of the carriageway.
    - (b) **Barbot Close**, the north-west side, between a point in line with the south-westerly flank wall of flats 14 – 22 Barbot Close, around the turning head and southern extent of the carriageway.
    - (c) **Beech Close**, the south-east side, from the south-western kerb-line of Woodstock Crescent and a point 5 metres south-west of that kerb-line.
    - (d) **Hydefield Court**, the north-west to south-east arm on the south-west side, from a point 14.5 metres north-west of the north-western kerb-line of the north-east to south-west arm of Hydefield Court, north-westward for a distance of 4 metres.
    - (e) **Woodstock Crescent**, the south-west side, from the south-eastern kerb-line of Beech Close and a point 5 metres south-east of that kerb-line.
  - (3) Convert the existing single yellow line to “at any time” waiting restrictions on Nestor Avenue,
    - (a) the west side, at the side of No. 23 The Grangeway.
    - (b) the west side, outside Nos. 1a to 1c Nestor Avenue.
    - (c) the east side, outside Nos. 14 to 22 Nestor Avenue.
    - (d) the east side, outside No. 12 Nestor Avenue.
    - (e) the east side, at the side of No. 21 The Grangeway.
2. A copy of the Orders and other documents giving detailed particulars about them can be inspected at the Town Library, 66 Church Street, Enfield EN2 6AX, Monday to Fridays 9am – 5pm inclusive, or online at: <https://new.enfield.gov.uk/services/roads-and-transport/traffic-management-orders/> until the last day of a period of six weeks beginning with the date on which the Orders were made.
3. If any person wishes to question the validity of the Orders or of any of their provisions on the grounds that they are not within the powers conferred by the Road Traffic Regulation Act 1984, or that any requirement of that Act or of any instrument made under that Act has not been complied with, that person may, within 6 weeks from the date on which the Orders are made, apply for the purpose to the High Court.

Dated 11/03/2026

Hussain Rab  
Head of Design and Construction  
(The officer appointed for this purpose)

# **The Enfield (Waiting and Loading Restriction) (Amendment No. 274) Order 2026**

## **Statement of Reasons**

### **Barbot Close, N9**

Enfield Council is proposing double yellow lines at the southern end of Barbot Close.

The restrictions are being introduced in response to London Fire Brigade raising the issue of emergency access to the block of flats at the end of Barbot Close. Currently cars park on both sides of the road which makes road inaccessible for fire appliances.

### **Beech Close jw Woodstock Crescent, N9**

Enfield Council is proposing double yellow lines at the southern side of Beech Close as well extending the existing double yellow lines on the northern corner junction with Woodstock Crescent.

Currently vehicles park on the both sides of the road which regularly causes access issues to our waste collection teams. These measures will also ensure access for emergency vehicles is maintained at all times.

### **Byland Close, N21**

Enfield Council is proposing to extend the double yellow lines into Byland Close on the northern side of the road from the junction with The Glade.

The parking restrictions are being proposed in response to the issue of missed refuse collections and access for Dial-a-Ride buses. The proposed extension of double yellow lines will also help with emergency access.

### **Hydefield Court (Keats Surgery entrance), N9**

Enfield Council is proposing to introduce double yellow lines at the north-west end of Hydefield Court adjacent to the car park entrance for Keats GP Surgery.

The parking restrictions are being proposed as vehicle parking at this end of Hydefield Court affects access for larger emergency vehicles to the surgery car park.

### **Nestor Avenue, N21**

Enfield Council is proposing to upgrade the single yellow lines on Nestor Avenue to double yellow lines.

The parking restrictions are being proposed to deal with the issue of parking on the both sides of the carriageway outside of the current 1-hour restriction making access for larger vehicles in particular emergency vehicles a problem.

## **Tasmania Terrace, N18**

Enfield Council is proposing to implement double yellow lines on the southern side of Tasmania Terrace.

Currently vehicles park on the both sides of the road which regularly causes access issues to our waste collection teams. These measures will also ensure access for emergency vehicles is maintained at all times.



**THE COUNCIL OF THE LONDON BOROUGH OF ENFIELD  
TRAFFIC MANAGEMENT ORDER**

2026 No. 18

---

The Enfield (Waiting and Loading Restriction) (Amendment No. 274) Traffic Order  
2026

Made: 9<sup>th</sup> March 2026

Coming into operation: 19<sup>th</sup> March 2026

---

The Council of the London Borough of Enfield, after consulting the Commissioner of Police of the Metropolis, in exercise of the powers conferred by sections 6 and 124 of and Part IV of Schedule 9 to the Road Traffic Regulation Act 1984(a) as amended, and of all other powers thereunto enabling, hereby make the following Order:

1. This Order shall come into operation on 19<sup>th</sup> March 2026 and may be cited as the Enfield (Waiting and Loading Restriction) (Amendment No. 274) Order 2026.
2. In this Order the expression “enactment” means any enactment, whether public general or local, and includes any order, bye-law, rule, regulation, scheme or other instrument having effect by virtue of an enactment and any reference in this Order to any enactment shall be construed as a reference to that enactment as amended, applied, consolidated, re-enacted by or as having effect by virtue of any subsequent enactment.
3. Without prejudice to the validity of anything done or to any liability incurred in respect of any act or omission before the coming into operation of this Order, the Enfield (Waiting and Loading Restriction) Order 2012(b) shall have effect as though:
  - (1) for the items numbered 2014 (Barbot Close), 709 (Beech Close), 1072 (Hydefield Court), 597 (Nestor Avenue), 1767 (Tasmania Terrace), and 1955 (Woodstock Crescent) in Schedule 1 to that Order there were substituted the item similarly numbered and set out in columns 1, 2 and 3 of Schedule 1 to this Order; and,

---

(a) 1984 c.27

(b) LBE 2012/1 as amended

- (2) there were added to Schedule 1 to that Order the item numbered 2028 (Byland Close) and set out in columns 1, 2 and 3 of Schedule 2 to this Order.

Dated this 9<sup>th</sup> day of March 2026



Hussain Rab  
Head of Design and Construction  
(The officer appointed for this purpose)

## SCHEDULE 1

1	2	3
2014.	<p><b>Barbot Close</b></p> <p>(a) the north-west side</p> <p>(i) between a point 4.4 metres south-west of the common boundary of Nos. 6 and 7 Barbot Close and a point 25.3 metres north-west of the common boundary of Nos. 1 and 2 Barbot Close.</p> <p>(ii) between a point in line with the south-western flank wall of flats 14 to 22 Barbot Close, around the turning head and along the southern extent of the carriageway.</p> <p>(b) the south-east side</p> <p>(i) between a point 7 metres south of the southernmost wall of Nos. 76-78 Barbot Close and a point 2 metres north of the northern wall of Nos. 76 to 78 Barbot Close.</p> <p>(ii) between a point 1.5 metres south-west of a point opposite the common boundary of Nos. 6 and 7 Barbot Close and a point 1.1 metres south-west of the northern building line of Nos. 43 to 51 Barbot Close.</p> <p>(iii) from a point 11.1 metres south-west of the north-eastern flank wall of flats 43 to 51 Barbot close to the southern extent of the carriageway.</p>	<p>A</p> <p>A</p> <p>A</p> <p>A</p> <p>A</p>
709.	<p><b>Beech Close</b></p> <p>(a) the south-east side, between the south-western kerb-line of Woodstock Crescent and a point 5 metres south-west of that kerb-line.</p> <p>(b) the north-west side, between the south-western kerb-line of Woodstock Crescent and a point 40 metres south-west of that kerb-line.</p>	<p>A</p> <p>A</p>
1072.	<p><b>Hydefield Court</b></p> <p>(A) the north-east to south-west arm</p> <p>(a) the north-west side</p> <p>(i) between the south-western kerb-line of Church Street, Edmonton and a point 10 metres south-west of that kerb-line;</p>	<p>A</p>

1	2	3
	<p>(ii) between the north-eastern kerb-line of the north-west to south-east arm of Hydefield Court north-eastward for a distance of 6 metres.</p> <p>(b) the south-east side, for its entire length.</p> <p>(B) the north-west to south-east arm</p> <p>(a) the north-east side, between a point 6 metres south-east of the south-eastern kerb-line of the north-east to south-west arm of Hydefield Court and its north-western extremity.</p> <p>(b) the south-west side, between a point 3 metres north-west of the north-western kerb-line of the north-east to south-west arm of Hydefield Court and a point 29 metres south-east of a point opposite the north-western wall of Nos. 2 to 24 Hydefield Court.</p> <p>(c) the south-west side, between a point 14.5 metres north-west of the north-western kerb-line of the north-east to south-west arm of Hydefield Court and a point 4 metres north-west of that point.</p>	<p>A</p> <p>A</p> <p>A</p> <p>A</p> <p>A</p>
597.	<p><b>Nestor Avenue</b></p> <p>(a) the east side</p> <p>(i) from the south-western kerb-line of The Grangeway south-westward for 5 metres.</p> <p>(ii) from a point 15 metres south of the south-western kerb-line of The Grangeway southward for 7 metres.</p> <p>(iii) between a point 27.2 metres south of the south-western kerb-line of The Grangeway and a point 34 metres south of that kerb-line;</p> <p>(iv) between a point 38.5 metres south of the south-western kerb-line of The Grangeway and the southern extremity of Nestor Avenue, so much of the carriageway that is public highway;</p> <p>(b) the west side</p> <p>(i) from the south-western kerb-line of The Grangeway south-westward for 5 metres.</p>	<p>A</p> <p>A</p> <p>A</p> <p>A</p> <p>A</p> <p>A</p> <p>A</p>

1	2	3
	<p>(ii) between a point 15 metres south of the south-western kerb-line of The Grangeway and a point 18.3 metres south of that kerb-line;</p> <p>(iii) between a point 24.5 metres south of the south-western kerb-line of The Grangeway and a point 2 metres north of the northern flank wall of No. 3 Nestor Avenue;</p> <p>(iv) between a point 4 metres north of a point opposite the southern flank wall of No. 13 Nestor Avenue and its southern extremity, so much of the carriageway that is public highway.</p>	<p>A</p> <p>A</p>
1767.	<p><b>Tasmania Terrace</b></p> <p>(a) the north-west side</p> <p>(i) between the south-western Kerb-line of Queensland Avenue and a point 7.5 metres south-west of that kerb-line.</p> <p>(b) the south-east side</p> <p>(i) between the south-western Kerb-line of Queensland Avenue and a point 12 metres south-west of the common boundary of Nos. 9 and 11 Tasmania Terrace.</p>	<p>A</p> <p>A</p>
1955.	<p><b>Woodstock Crescent</b></p> <p>(a) the north-east and south-east side</p> <p>(i) between a point 11 metres south-west of the south-western wall of No. 21a Woodstock Crescent and a point 1 metre north-west of the north-western wall of No. 17a Woodstock Crescent;</p> <p>(b) the south-west side</p> <p>(i) between the south-eastern kerb-line of Beech Close and a point 5 metres south-east of that kerb-line.</p>	<p>A</p> <p>A</p>

**SCHEDULE 2**

1	2	3
<b>2028.</b>	<b>Byland Close</b> the north-west side, between the southwestern kerb-line of The Glade and a point 5 metres south-west of that kerb-line.	A



**EXPLANATORY NOTE**

This Order further amends the Enfield (Waiting and Loading Restriction) Order 2012, so as to introduce new “at any time” waiting restrictions in Barbot Close, Byland Close, Beech Close, Hydefield Court, Nestor Avenue, Tasmania Terrace, and Woodstock Crescent, in the London Borough of Enfield.





**KEY**

-  **EXISTING 2 WHEEL ON PARKING BAY**
-  **PROPOSED DOUBLE YELLOW LINES**
-  **EXISTING DOUBLE YELLOW LINES (TO BE REFRESHED)**

**NOTES**

1. DO NOT SCALE FROM THIS DRAWING.
2. ANY ERRORS OR OMISSIONS TO BE BROUGHT TO THE ENGINEERS ATTENTION IMMEDIATELY FOUND.
3. ALL DIMENSIONS ARE IN METRES UNLESS OTHERWISE SHOWN.
4. ALL LEVELS ARE IN METRES AND RELATE TO ORDNANCE DATUM LEVEL UNLESS NOTED OTHERWISE.
5. THIS DRAWING IS TO BE READ IN CONJUNCTION WITH ALL OTHER DRAWINGS IN THE SAME SERIES.

A	DIMENSIONS ADDED	02/26
Rev	Revision details	

**STATUS**  
**DETAILED DESIGN**

**CLIENT**  
**LONDON BOROUGH OF ENFIELD**

**JOB TITLE**  
**LARGE VEHICLE ACCESS PROGRAMME BEECH CLOSE**

**DRAWING TITLE**  
**PROPOSED PARKING RESTRICTIONS VEHICLE ACCESS**

Enfield Council  
52, Civic Centre  
Silver Street, Enfield  
EN1 3XY  
Tel: 020 8379 1000  
www.enfield.gov.uk



**HIGHWAYS AND TRANSPORTATION**  
**Highway Improvements**

DESIGNED:- <b>MD</b>	DRAWN:- <b>MD</b>	DATE:- <b>MAR 2026</b>
SCALE:- <b>NTS</b>	PLOT SCALE:- <b>1:1</b>	CHECKED:- <b>CG</b>

<b>DRAWING NO.</b>	<b>18314-02</b>	<b>A</b>
--------------------	-----------------	----------

10 0 10 20 50 100mm NATURAL SCALE





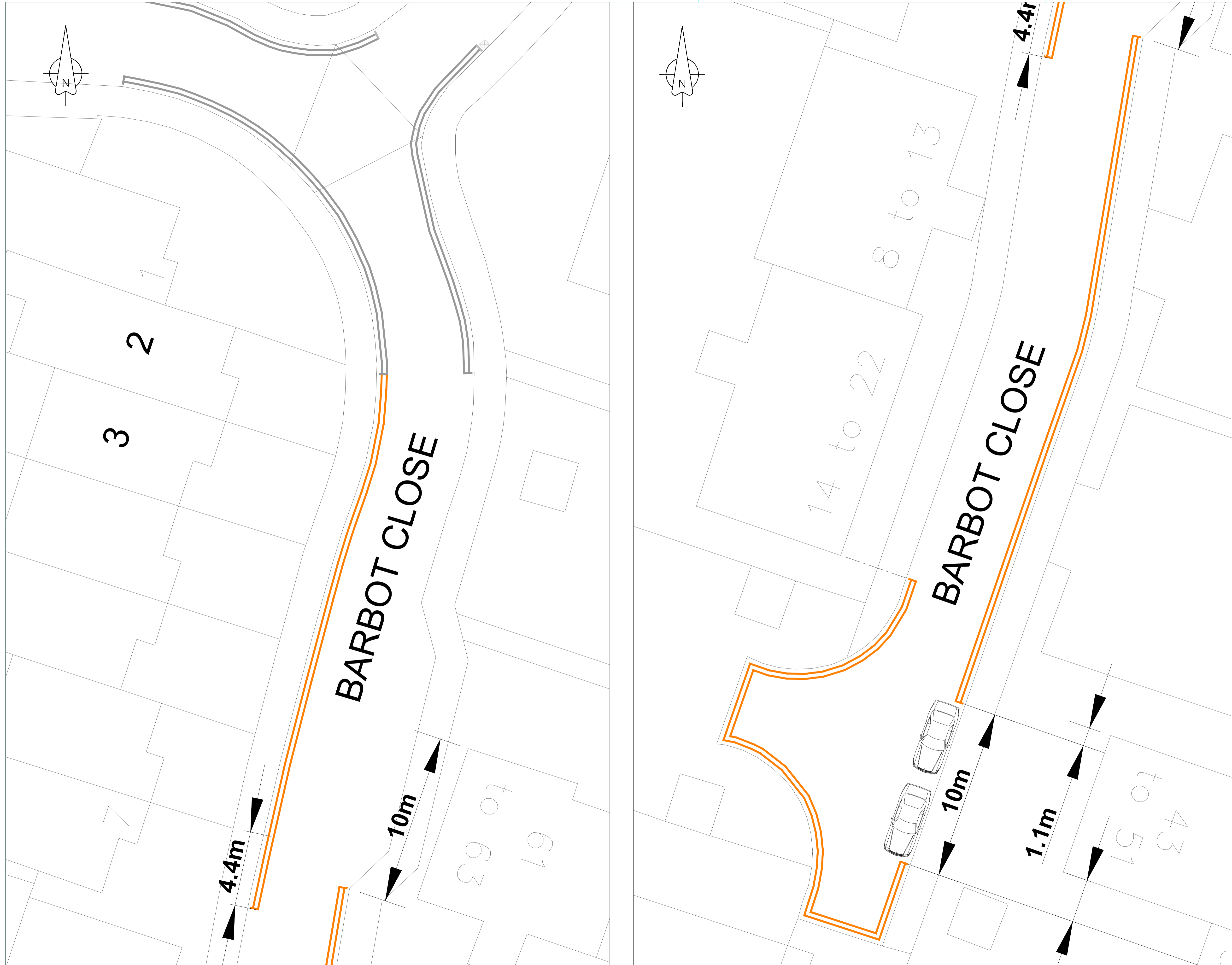

- NOTES**
- DO NOT SCALE FROM THIS DRAWING.
  - ANY ERRORS OR OMISSIONS TO BE BROUGHT TO THE ENGINEERS ATTENTION IMMEDIATELY FOUND.
  - ALL DIMENSIONS ARE IN MILLIMETRES UNLESS OTHERWISE SHOWN.
  - ALL LEVELS ARE IN METRES AND RELATE TO ORDNANCE DATUM LEVEL UNLESS NOTED OTHERWISE.
  - THIS DRAWING IS TO BE READ IN CONJUNCTION WITH ALL OTHER DRAWINGS IN THE SAME SERIES.

- KEY**
- New double yellow lines
  - Existing double yellow lines

Rev	Revision details	Date
A	DIMENSION ADDED	02/26

© Crown Copyright. All Rights Reserved. London Borough of Enfield. All General, Reproduction, Distribution, or otherwise, without the prior written consent of the London Borough of Enfield is prohibited.

**STATUS**  
DETAILED DESIGN

**CLIENT**  
LONDON BOROUGH OF ENFIELD

**JOB TITLE**  
LARGE VEHICLE ACCESS PROGRAMME  
BARBOT CLOSE

**DRAWING TITLE**  
PROPOSED WAITING RESTRICTIONS



London Borough of Enfield  
Civic Centre, Enfield  
7 Watling Drive, Enfield  
EN9 1JH  
Tel: 020 8276 3400 Fax: 020 8276 3404  
E: local\_highway\_services@enfield.gov.uk



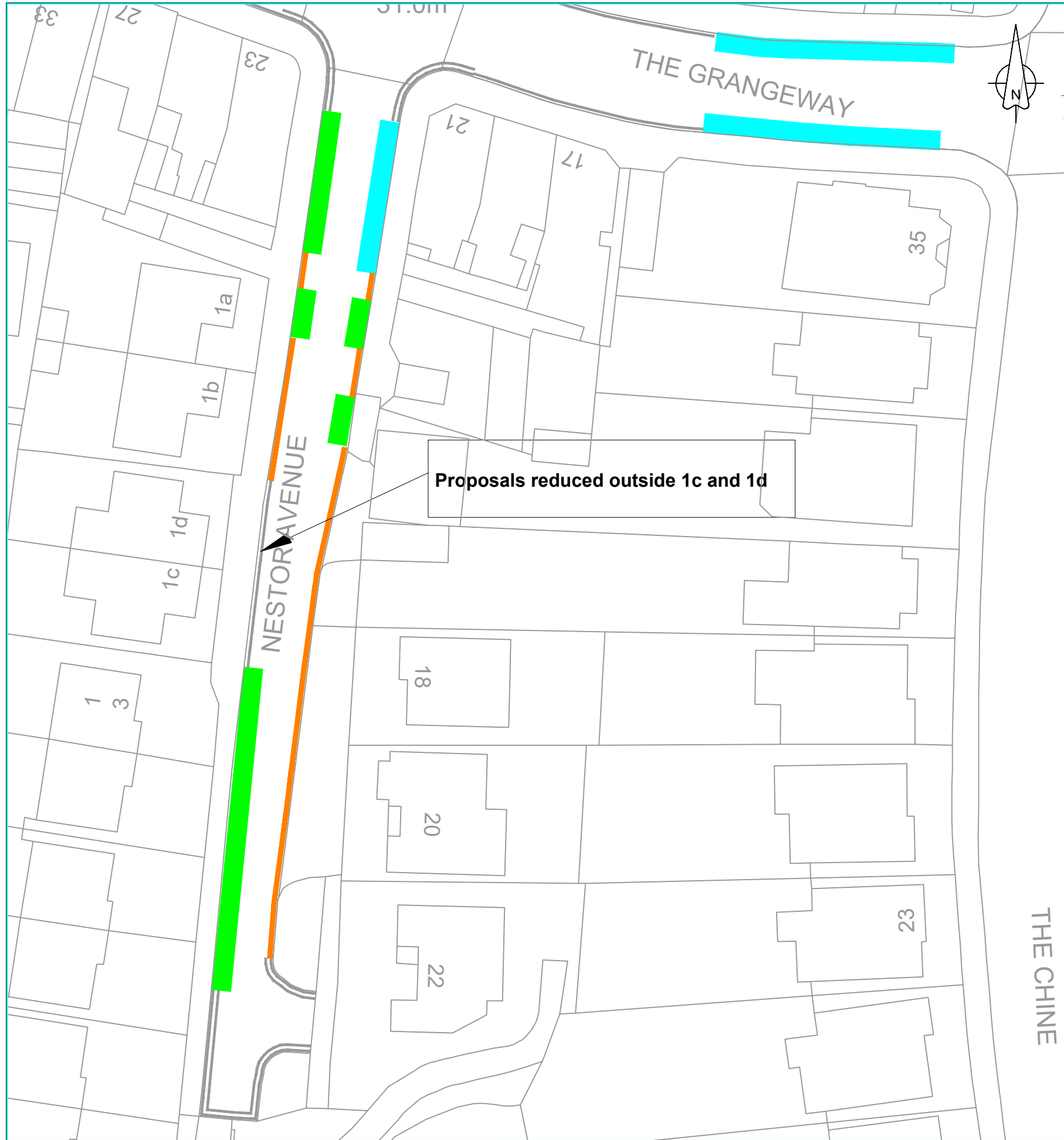

DESIGNED:- MD	DRAWN:- MD	DATE:- MAR 2026
CHECKED:- NTS	PLOT SCALE:- 1:1	CHECKED:- CG

DRAWING NO. 18317-01 A



Proposals reduced outside 1c and 1d

**KEY**

-  **EXISTING RESIDENT PERMIT BAY**
-  **EXISTING BUSINESS PERMIT BAY**
-  **EXISTING SINGLE YELLOW LINE TO BE UPGRADED TO DOUBLE YELLOW LINES**
-  **EXISTING DOUBLE YELLOW LINES**
-  **EXISTING SINGLE YELLOW LINES TO REMAIN**

**NOTES**

1. DO NOT SCALE FROM THIS DRAWING.
2. ANY ERRORS OR OMISSIONS TO BE BROUGHT TO THE ENGINEERS ATTENTION IMMEDIATELY FOUND.
3. ALL DIMENSIONS ARE IN METRES UNLESS OTHERWISE SHOWN.
4. ALL LEVELS ARE IN METRES AND RELATE TO ORDNANCE DATUM LEVEL UNLESS NOTED OTHERWISE.
5. THIS DRAWING IS TO BE READ IN CONJUNCTION WITH ALL OTHER DRAWINGS IN THE SAME SERIES.

Rev	Revision details

©CROWN COPYRIGHT. ALL RIGHTS RESERVED. LONDON BOROUGH OF ENFIELD LA 081563. UNAUTHORISED REPRODUCTION OF ORDNANCE SURVEY MAPPING INFRINGES CROWN COPYRIGHT AND MAY LEAD TO PROCEEDINGS.

**STATUS**  
**DETAILED DESIGN**

**CLIENT**  
**LONDON BOROUGH OF ENFIELD**

**JOB TITLE**  
**LARGE VEHICLES ACCESS PROGRAMME NESTOR AVENUE**

**DRAWING TITLE**  
**PROPOSED PARKING RESTRICTIONS**

Enfield Council  
52, Civic Centre  
Silver Street, Enfield  
EN1 3XY  
Tel: 020 8379 1000  
www.enfield.gov.uk



**HIGHWAYS AND TRANSPORTATION**  
**Highway Improvements**

DESIGNED:- <b>MD</b>	DRAWN:- <b>MD</b>	DATE:- <b>MAR 2026</b>
SCALE:- <b>NTS</b>	PLOT SCALE:- <b>1:1</b>	CHECKED:- <b>CG</b>

**DRAWING NO. 18313-01**

