

## A406 Road Closure - Warwick Road Access Arrangements

Transport for London will be implementing three\* nightly road closures of a section of the A406 in order to facilitate essential resurfacing works at the junction with Bowes Road and Wilmer Way. This document is intended to inform residents of Warwick Road and adjoining streets of the access routes to be used whilst the closure is in place. **Please note, the 'no motor vehicle' restriction at the southern end of Warwick Road will remain in force.**

### Road Closure Dates and Timings

30th August - 10pm until 5am

31st August - 10pm until 5am

1st September - 10pm until 5am

\*2nd September - Contingency date if required, 10pm until 5am

### Road Closure Area

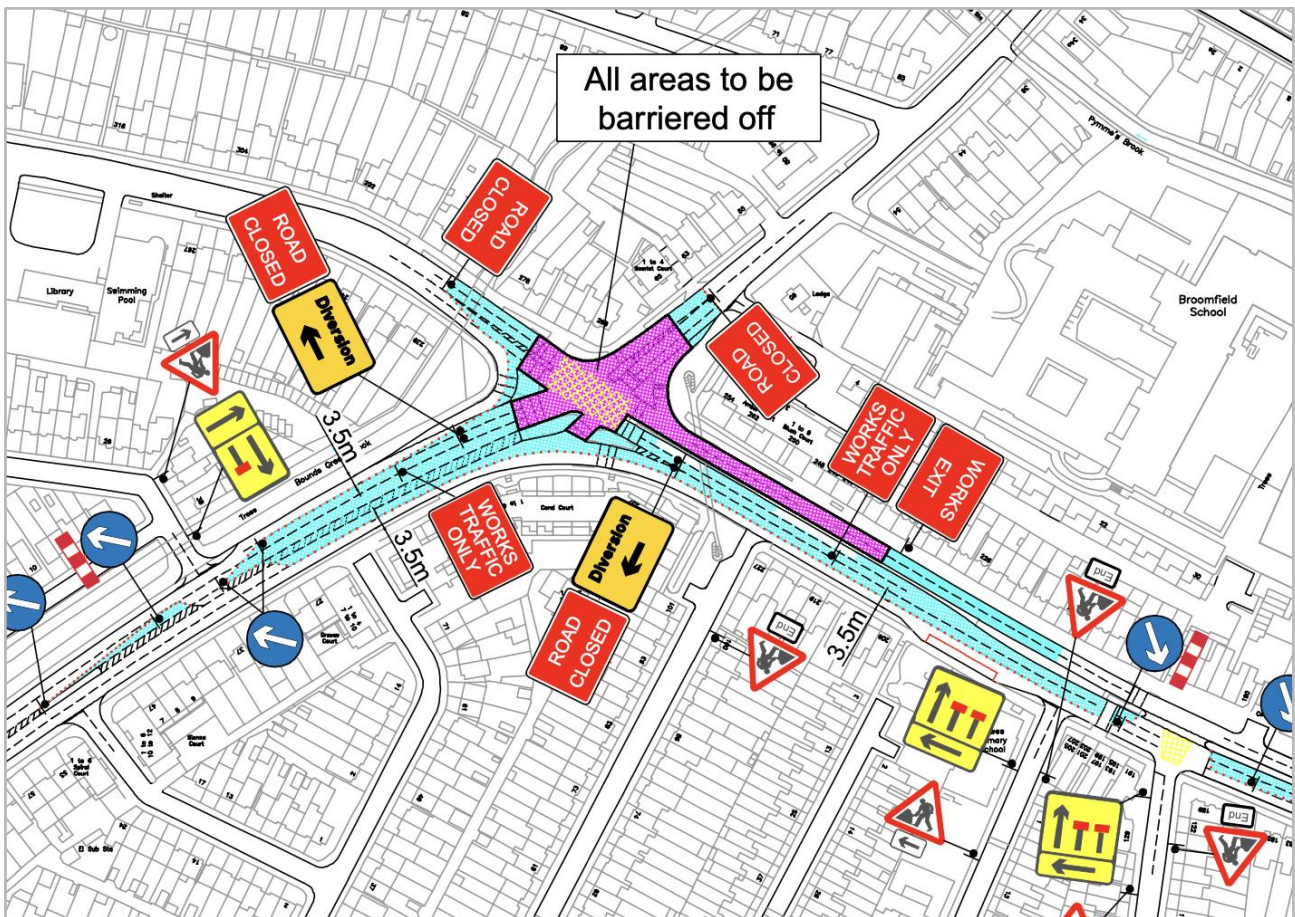

## Access Arrangements - Warwick Road and Adjoining Streets

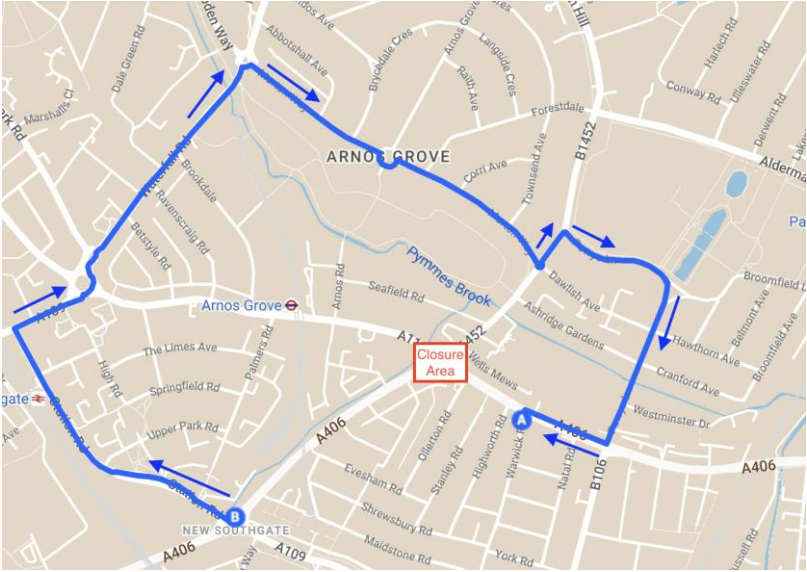
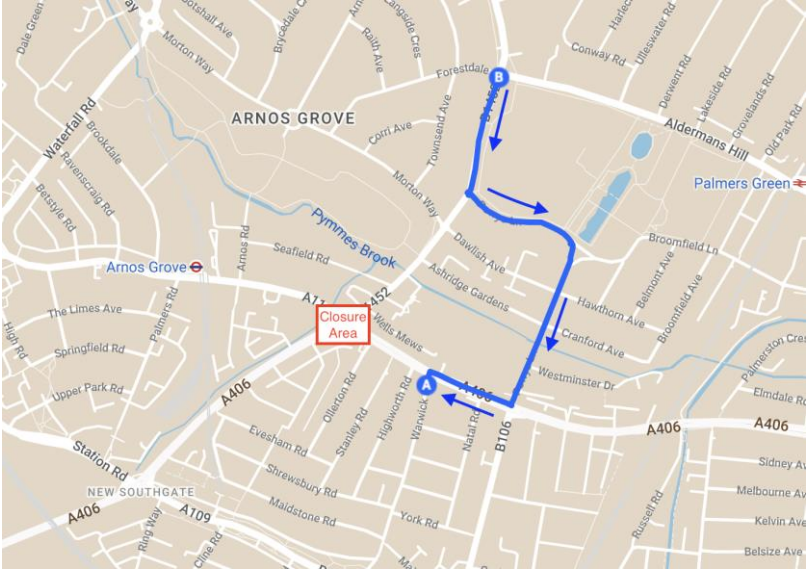
Local Diversion Routes	Route Information
	<p>Station Road</p> <p>Frein Barnet Road</p> <p>Waterfall Road</p> <p>Morton Way</p> <p>Cannon Hill</p> <p>Powys Lane</p> <p>A406</p>
	<p>Cannon Hill</p> <p>Powys Lane</p> <p>A406</p>

**For Further Information please contact:**

[contactus@tfl.gov.uk](mailto:contactus@tfl.gov.uk)